

ZON™

BEARINGS FOR YOUR FUTURE



Nadellager / Needle Roller Bearings





BEARINGS FOR YOUR FUTURE

Zen Ball Bearings are manufactured to the highest quality for standard and non-standard applications. Our technical department can modify any non-standard bearings to your specific requirements, regardless of quantity.

Apart from our extensive miniature ball bearing range of more than 1000 different types, ranging from 1-10 mm bore (Including inch dimensions), our range also includes Thin section, Three part thrust, Popular metric and any kind of non standard bearing. We are able to design bearings according to your requirements using new materials like ceramic or special steels for applications in Industry, Medicine, Chemistry and Food Processing.

Our technical department can modify any non-standard bearings to your specific requirements, even for small quantities.

For any items not listed in our catalogue, please contact our experienced sales team.



Zen Ball Bearings Shanghai has been awarded the German ISO TUV Rheinland certification for inspection of ZEN products.

This certification is the highest standard a business in our industry can achieve.

It is internationally recognised as a guarantee of quality, customer focus and continual improvement.

www.zen.biz



Nadellager Needle Roller Bearings



Ölschmierung
Oil lubrication



Fettschmierung
Grease lubrication



Geeignet für hohe drehzahlen
Suitable for high speed applications



Geeignet für hohe tragzahlen
Suitable for heavy load rating



Gummidichtscheiben verfügbar
Rubber seal option available

Nadellager / Needle Roller Bearings

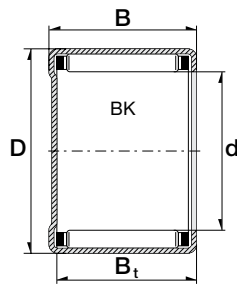
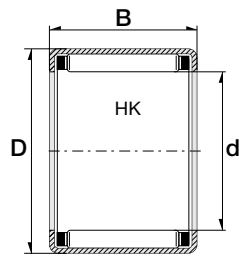

Needle Roller Bearings
HK series with open ends

Drawn Cup
Needle Roller Bearings
BK series with closed end



3

Designation/Type		Dimension (mm)				* Load Rating		Limiting speed x1000rpm
with open ends	with closed end	d	D	B Tol.-0.3	B _t min. only BK	C, dyn. N	C, stat. N	
HK 0608	-	6	10	8	-	1980	1540	34.0
HK 0609	BK 0609	6	10	9	7.4	2650	2400	35.0
HK 0709	BK 0709	7	11	9	7.4	2850	2750	30.0
HK 0808	BK 0808	8	12	8	6.4	2550	2400	27.0
HK 0810	BK 0810	8	12	10	8.4	3500	3650	27.0
HK 0908	-	9	13	8	-	3300	3500	26.0
HK 0910	BK 0910	9	13	10	8.4	4000	4300	26.0
HK 0912	BK 0912	9	13	12	10.4	5000	5900	26.0
HK 1010	BK 1010	10	14	10	8.4	4100	4700	22.0
HK 1012	BK 1012	10	14	12	10.4	5100	6300	22.5
HK 1015	BK 1015	10	14	15	13.4	6300	8200	22.0
HK 1210	BK 1210	12	16	10	8.4	4600	5800	21.0
HK 1212	BK 1212	12	18	12	9.3	6000	6800	19.5
HK 1312	BK 1312	13	19	12	9.3	6300	7300	18.5
HK 1412	BK 1412	14	20	12	9.3	6600	7900	15.0
HK 1512	BK 1512	15	21	12	9.3	7300	8700	15.0
HK 1516	BK 1516	15	21	16	13.3	9800	13400	15.5
HK 1612	BK 1612	16	22	12	9.3	7100	9000	15.0
HK 1616	BK 1616	16	22	16	13.3	10100	14200	15.0
HK 1712	-	17	23	12	-	7300	5600	13.5
HK 1812	BK 1812	18	24	12	9.3	7500	10100	13.0
HK 1816	BK 1816	18	24	16	13.3	10800	16000	14.0
HK 2010	-	20	26	10	-	6000	7600	11.5
HK 2012	-	20	26	12	-	8000	11200	12.0
HK 2016	BK 2016	20	26	16	13.3	12000	19000	12.5

Nadellager / Needle Roller Bearings

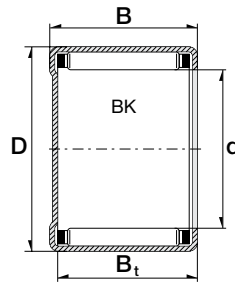
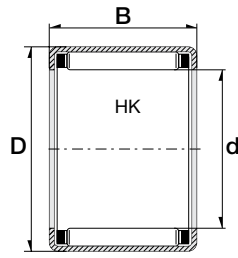

Needle Roller Bearings
HK series with open ends

Drawn Cup
Needle Roller Bearings
BK series with closed end



4

Designation/Type		Dimension (mm)				* Load Rating		Limiting speed x1000rpm
with open ends	with closed end	d	D	B Tol.-0.3	B _t min. only BK	C, dyn. N	C, stat. N	
HK 2020	BK 2020	20	26	20	17.3	15500	24000	12.0
HK 2210	-	22	28	10	-	7000	10000	11.5
HK 2212	BK 2212	22	28	12	9.3	8500	12500	11.5
HK 2216	BK 2216	22	28	16	13.3	12500	20500	11.5
HK 2220	-	22	28	20	-	15000	27000	11.5
HK 2512	-	25	32	12	-	10000	15000	9.5
HK 2516	-	25	32	16	-	14500	22000	10.0
HK 2520	BK 2520	25	32	20	17.3	18500	30000	10.0
HK 2526	BK 2526	25	32	26	23.3	23500	42000	10.0
HK 2816	-	28	35	16	-	15000	24500	8.5
HK 2820	-	28	35	20	-	20000	33500	8.5
HK 3012	BK 3012	30	37	12	9.3	11000	17000	8.5
HK 3016	BK 3016	30	37	16	13.3	16000	27000	8.5
HK 3020	BK 3020	30	37	20	17.3	21000	37000	8.5
HK 3026	BK 3026	30	37	26	23.3	26000	50000	8.5
HK 3512	-	35	42	12	-	12000	20000	7.0

Nadellager / Needle Roller Bearings

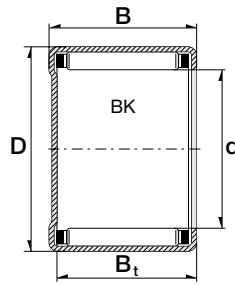
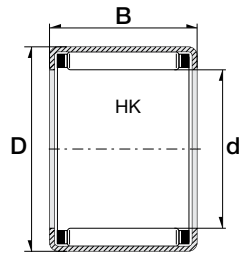

Needle Roller Bearings
HK series with open ends

Drawn Cup
Needle Roller Bearings
BK series with closed end



5

Designation/Type		Dimension (mm)				* Load Rating		Limiting speed x1000rpm
with open ends	with closed end	d	D	B Tol.-0.3	B _t min. only BK	C, dyn. N	C, stat. N	
HK 3516	-	35	42	16	-	18500	31000	7.0
HK 3520	BK 3520	35	42	20	17.3	22000	43000	7.5
HK 4012	-	40	47	12	-	13000	22600	6.0
HK 4016	-	40	47	16	-	18600	36000	6.0
HK 4020	BK 4020	40	47	20	17.3	24000	50000	6.0
HK 4512	-	45	52	12	-	14000	25500	5.5
HK 4516	-	45	52	16	-	20000	40500	5.5
HK 4520	BK 4520	45	52	20	17.3	25000	54500	5.5
HK 5020	-	50	58	20	-	29000	58500	5.0
HK 5025	-	50	58	25	-	35800	78000	4.8
HK 5520	-	55	63	20	-	29500	62300	4.6
HK 5528	-	55	63	28	-	41000	95800	4.6
HK 6012	-	60	68	12	-	16200	30000	4.1
HK 6020	-	60	68	20	-	31000	70000	4.4
HK 6032	-	60	68	32	-	49500	125500	4.4

www.zen.biz

Alle Rechte vorbehalten, kein Teil des Katalogs darf in irgendeiner Form (Druck, Fotokopie, Mikrofilm oder in einem anderen Verfahren) ohne Genehmigung reproduziert oder unter Verwendung elektronischer Systeme verarbeitet, vervielfältigt oder verbreitet werden.

Copyright reserved. No part of the catalogue is to be copied, extracted or modified without explicit permission from the copyright holder.

v.10 / 12



Bearings for your future